



JET-660-07

Rev.0.1 03 / 2021

PRELIMINARY

- Single Chip Design
- 660 nm, 300 mW
- Ultra Narrow Beam Angle
- Homogeneous Square Beam Pattern



Description

JET-660-07 is a single chip LED emitter, utilizing a single high power chip die with a clear epoxy lens offering **ultra low divergence beam** of perfectly square proportions. It features a full metal submount with **M12x1 thread** for convenient installation and ideal heat dissipation

Specifications

Parameter	Symbol	Values		Unit
		Min.	Max.	
Thermal Power	P_T		1200	mW
Operating Current	I_F		500	mA
Reverse Current (10V)	I_R		<5	μ A
Operating Temperature	T_{CASE}	- 20	+ 60	$^{\circ}$ C
Storage Temperature	T_{STG}	0	+ 40	$^{\circ}$ C
Soldering Temperature	T_{SOLDER}		260	$^{\circ}$ C

Electrical Connection ($I_F=350mA$)

Parameter	Symbol	Values			Unit
		Min.	Typ.	Max.	
Emission Wavelength	λ_{peak}	650	660	670	nm
Optical Output Power	P_O		300		mW
Spectral Width (FWHM)	$\Delta\lambda$		20		nm
Operating Voltage	V_F		2.1	2.2	V
Beam Divergence (FWHM)	θ		07	09	deg
Thermal resistance	K/W		17		
Rise/Fall time	t_R/t_F		30/40		ns





PRELIMINARY

Optical Characteristics

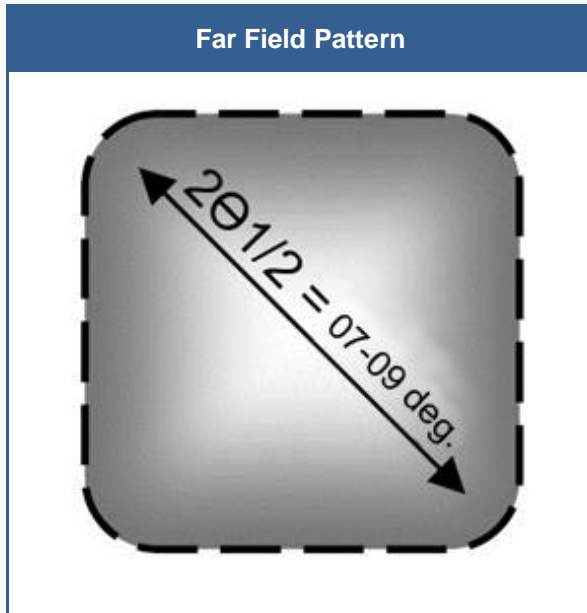

Drawing

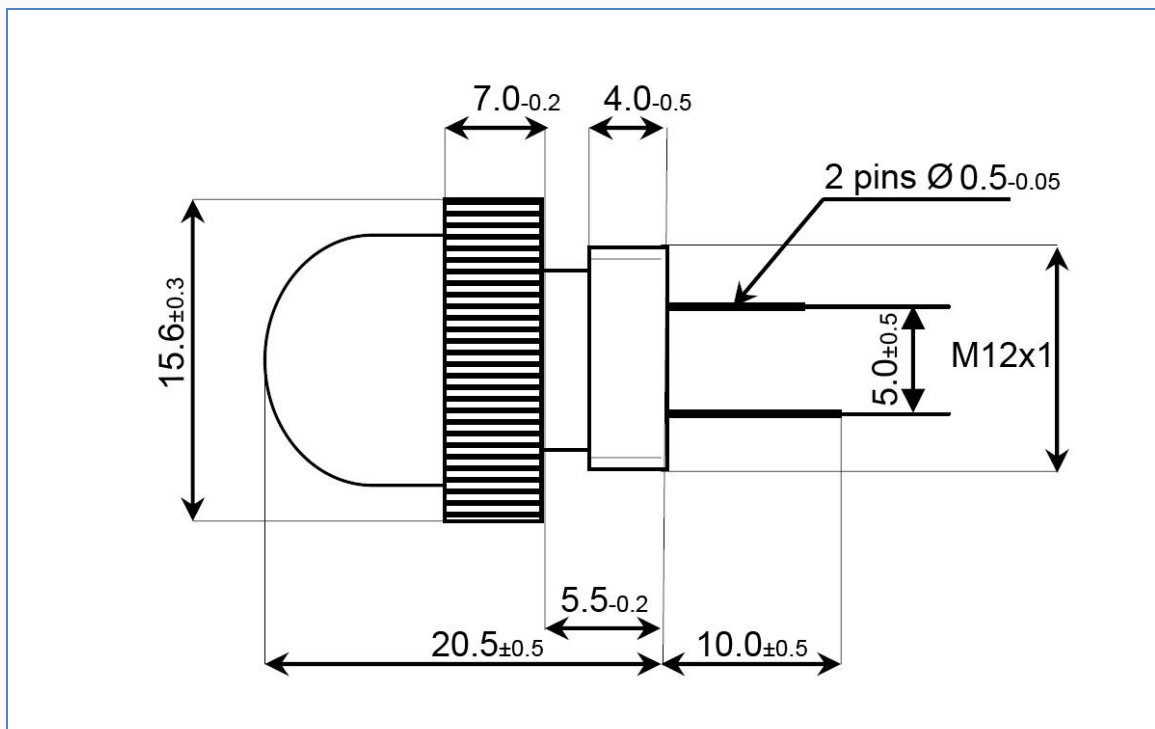

All dimensions in mm